

NEAR OUR NEIGHBORHOOD

- Business 40 (0.5 mi)
- Interstate 40 (1 mi)
- On the city bus line downtown (1.5 mi)
- Forsyth Hospital (2.9 mi)
- Wake Forest University
(Baptist Medical Center) (0.7 mi)
- Downtown Health Plaza (2.7 mi)
- Forsyth County Health
Department (3.2 mi)

Shopping Centers

- Hanes Mall (2.8 mi)
- Parkway Plaza (Peter's Creek) (1.5 mi)
- Market Place Mall (1.2 mi)

Airports

- Piedmont Triad Airport (25 mi)
- Smith Reynolds Airport (5 mi)

Schools

- Wake Forest University (6 mi)
- Salem College (1 mi)
- NC School of the Arts (2 mi)
- Winston-Salem State Univ. (2.5 mi)
- Forsyth Tech (1 mi)



730 Anson Street
Winston-Salem, North Carolina 27103
phone: 336-721-9111
fax: 336-721-9430

APARTMENTS



The Ledges

APARTMENTS

Compare our many features to other apartment communities.

- Location is great! See our list of nearby facilities.
- Central heat and air conditioning provided by very high efficient heat pumps (SEER 12)
- Vinyl insulated windows
- Programmable thermostats
- Lowest Duke Power residential electric rate
- Dishwashers & Garbage Disposals
- Slide-in ranges
- Frost-free refrigerators
- Washer / dryer connections
- Optional washers / dryers
- On-site laundromat
- Beautiful hardwood floors optional
- Ceramic tiled kitchen, bath, and tub surrounds
- Digital satellite and cable ready in living room and bedrooms
- Multi-line phone wiring at three locations
- Crystal clear swimming pool
- Two playgrounds
- Children's Center
- Classroom
- Courtesy officer

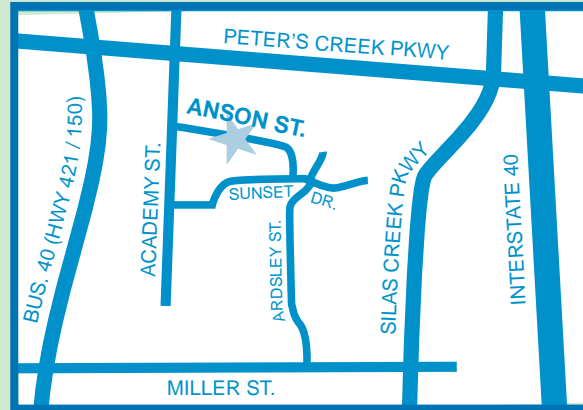

Directions:

From Business 40, go south on Peter's Creek Parkway. Turn right on Academy Street. Turn left on Anson St. Go one quarter of a mile and look for "The Ledges" sign.

One Bedroom Garden Apartment

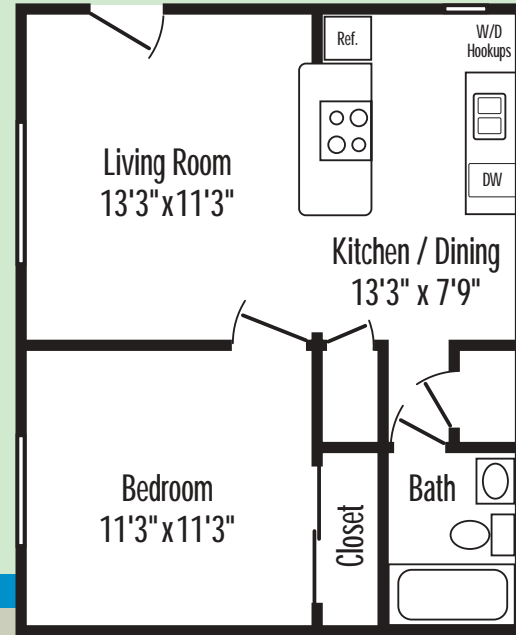

Two Bedroom Garden Apartment

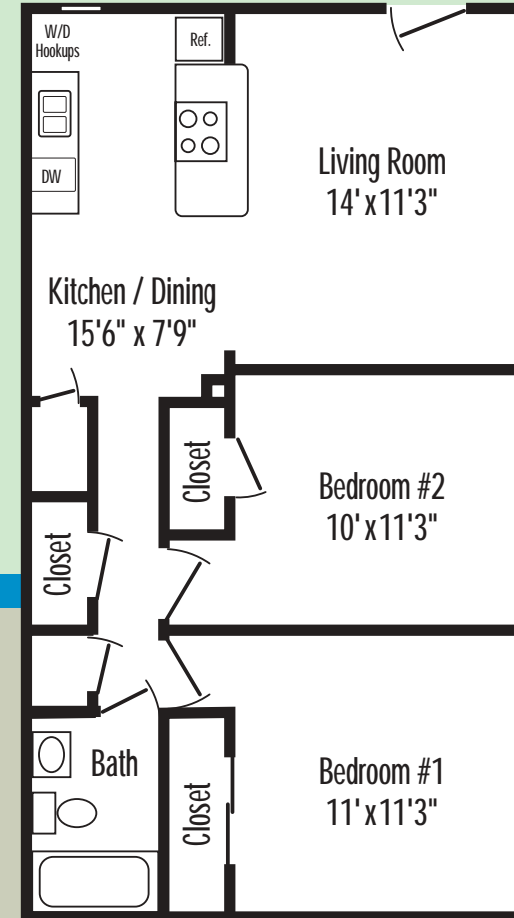

Three Bedroom Garden Apartment

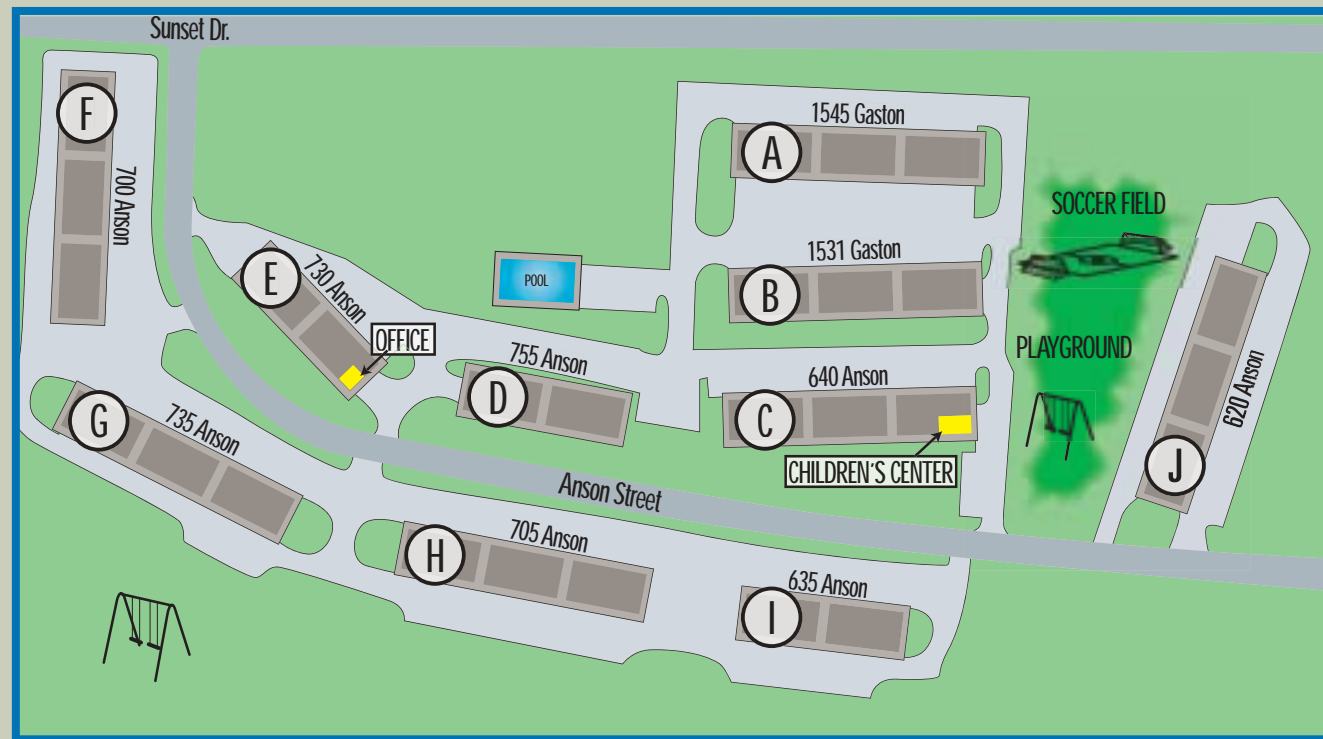
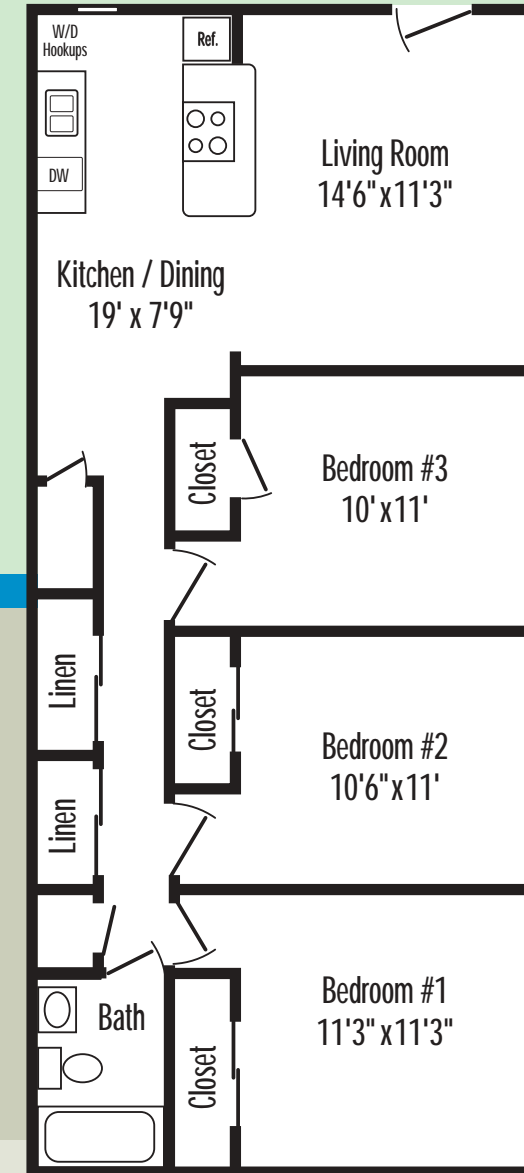

There's easy living at The Ledges. Whether you choose a one, two, or three bedroom garden apartment, you'll enjoy a relaxed, carefree lifestyle, all year long.

phone: 336-721-9111